

# VENT-N



## 5145890000 - VENT-125NK (220/240V50/60HZ) N6 - IN LINE DUCT FANS

In-line duct centrifugal fan, manufactured from high grade corrosion resistant pressed galvanized steel. Motor IP44, single phase, external rotor with thermal protector. Model VENT-125NK (220/240V50/60HZ) N6.

### Theoretical Working Point

Airflow	-
Static Pressure	-
Temperature	20 °C
Altitude	0 m
Density	1.2 kg/m <sup>3</sup>
Frequency	50 Hz
Voltage	1-230V-50Hz

### Construction

Diameter	125 mm
Fan size	125
Weight	3.00 kg

### Motor Characteristics

Number of poles	2
Motor Power	-
Voltage	1-230V-50Hz
Maximum absorbed current	0.3 A
IP Rating	IP44
Motor insulation class	F

### Drawing

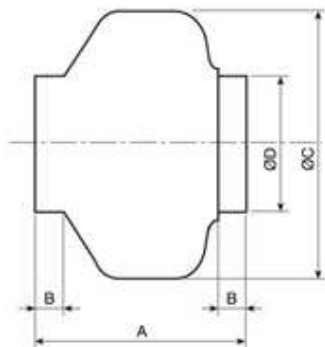

A	B	C	D
198	27	243	123

### Performance Chart

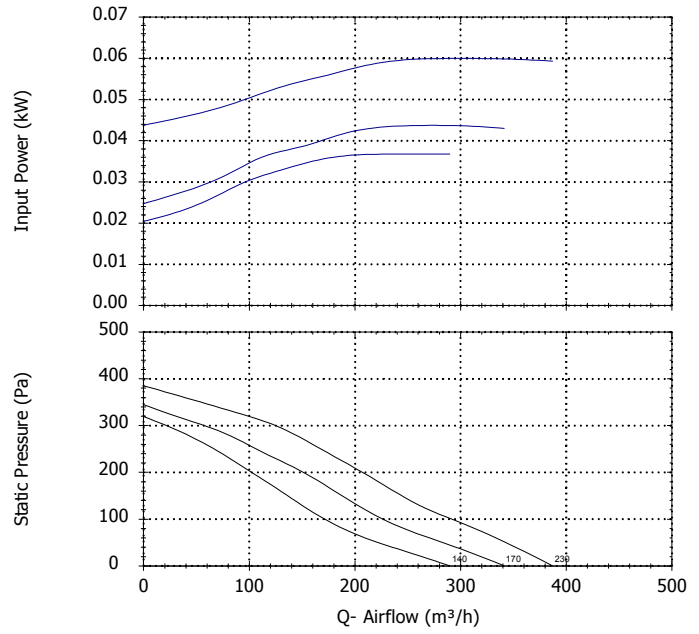

### Sound Performance

	63	125	250	500	1k	2k	4k	8k	Overall
<b>Inlet (LwA)</b>	33	42	54	64	67	66	62	49	71
<b>Inlet LpA @ 1m</b>	22	31	43	53	56	55	51	38	60
<b>Outlet (LwA)</b>	33	43	61	62	63	62	59	47	69
<b>Outlet LpA @ 1m</b>	22	32	50	51	52	51	48	36	58
<b>Breakout (LwA)</b>	20	34	49	45	53	49	50	37	57
<b>Breakout LpA @ 1m</b>	9	23	38	34	42	38	39	26	46



# VENT-N



5145890000 - VENT-125NK (220/240V50/60HZ) N6 - IN LINE DUCT FANS

## Performance Chart

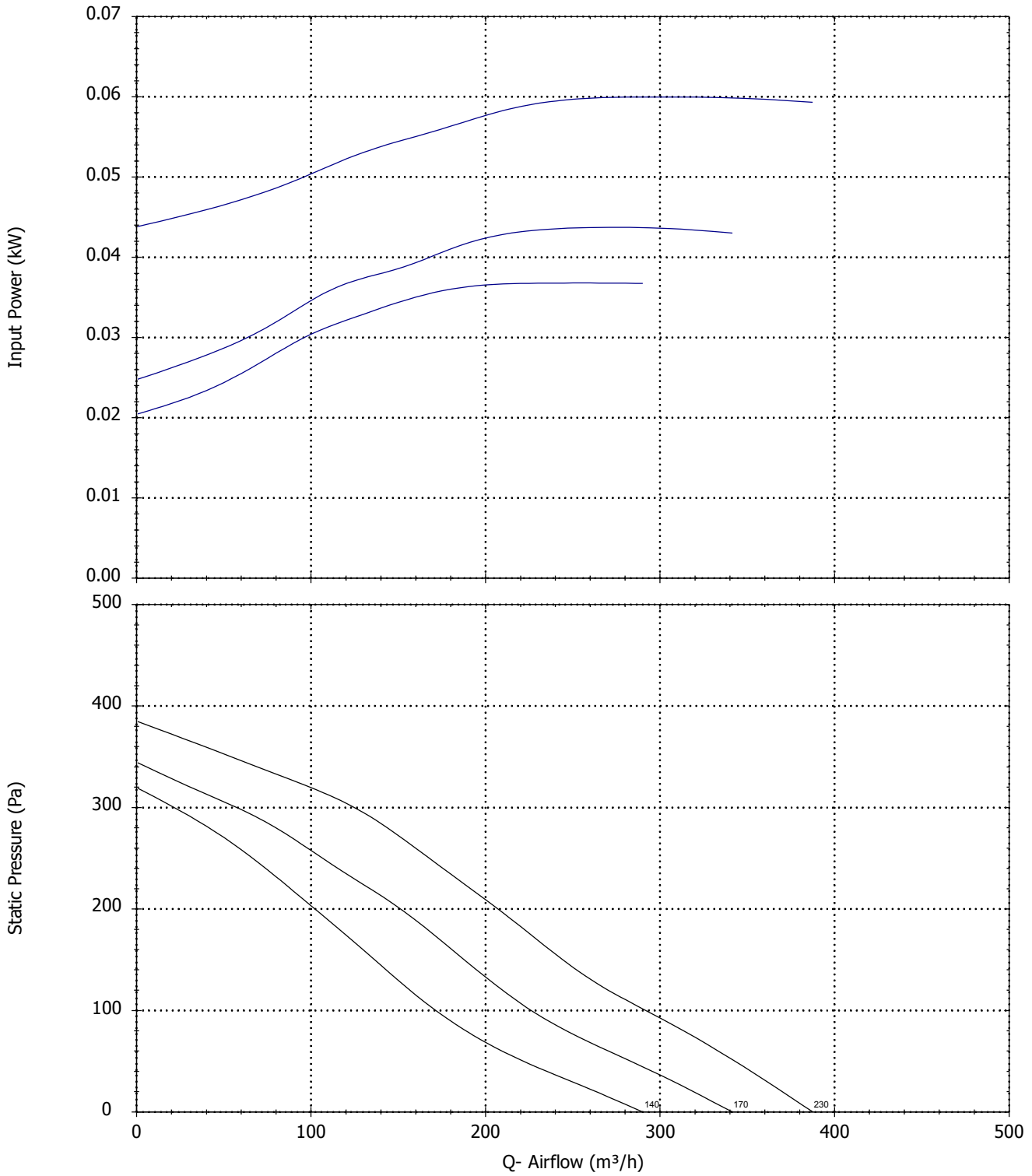

# VENT-N



5145890000 - VENT-125NK (220/240V50/60HZ) N6 - IN LINE DUCT FANS



## Drawing

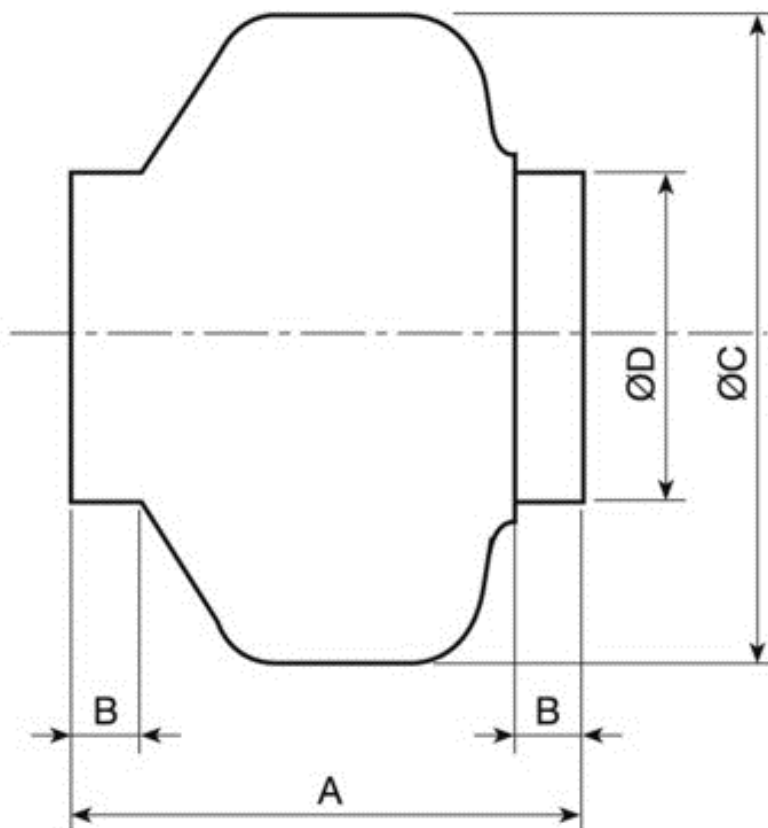

A	B	C	D
198	27	243	123



5145890000 - VENT-125NK (220/240V50/60HZ) N6 - IN LINE DUCT FANS

## Accessories



5145820600 - ACOP-VENT-125 (V977502)  
FLEXIBLE CONNECTOR



5416402500 - BOC-125  
inlet connector at the end of the duct

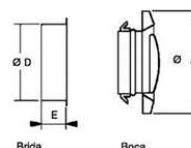

A	D	E
145	125	50



5416616000 - BORJ-125  
Canopy

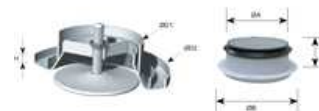

ØD1	ØD2	ØH	ØA	B	C
115	166	15	120	155	43



5416616100 - BORP-125  
Isolation damper



ØD1	ØD2	ØH	ØA	B	H2
115	166	15	115	155	100



5416443900 - CAR-125  
Back draft shutters to be installed within circular ducting to prevent back draft of air when the fans are switched off.

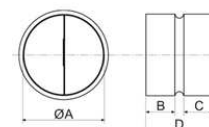

ØA	B	C	D
125	45	43	100

5416411600 - CX-125/215  
WORM DRIVE DUCT CLIPS



Ømin Øma  
125 215

5145801600 - DEF-VENT-125  
OUTLET WIRE PROTECTION GUARD

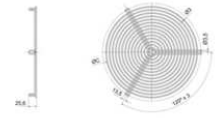

D  
124

5416480100 - GRI-125  
Extract louvre grilles manufactured from aluminium and finished with an epoxy polyester paint coating.

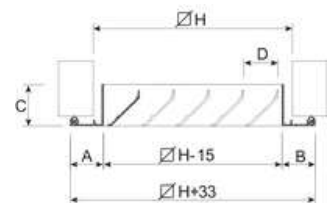

C	D	□H	A	B
30	25	125	24	24

5209192100 - GSA-M0 125 10M  
Flexible aluminium ducts made of a aluminium and polyester exterior covering a spiral steel wire frame. Used for general installations in detached or collective housing and commercial premises.

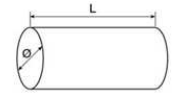

φ L  
125 10

5209150400 - GSA-M0 125 3M  
Flexible aluminium ducts made of a aluminium and polyester exterior covering a spiral steel wire frame. Used for general installations in detached or collective housing and commercial premises.

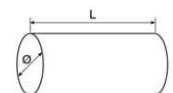

φ L  
125 3

5416464500 - GSI-M0/M1 125 10M  
INSULATED ALUMINIUM FLEXIBLE DUCTING

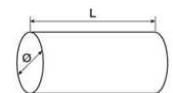

D L  
125 10

5209192300 - GSI-M0/M1 125 3M  
INSULATED ALUMINIUM FLEXIBLE DUCTING

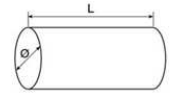

Ø	L
125	3



5211808400 - MBE-125/04B 1/230V  
ELECTRIC HEATER BATTERY

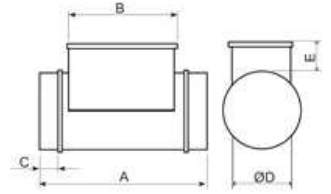

A	B	C	ØD	E
375	278	42	125	105



5211781200 - MBE-125/04B-R 1/230V  
ELECTRIC HEATER BATTERY

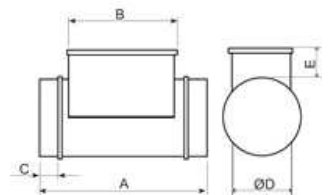

A	B	C	ØD	E
375	278	42	125	105



5211808500 - MBE-125/08B 1/230V  
ELECTRIC HEATER BATTERY

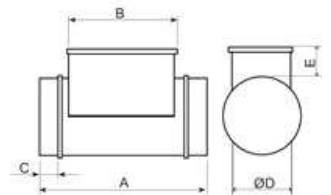

A	B	C	ØD	E
375	278	42	125	105



5211781300 - MBE-125/08B-R 1/230V  
ELECTRIC HEATER BATTERY

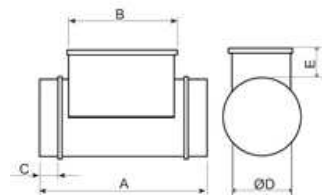

A	B	C	ØD	E
375	278	42	125	105



5211801500 - MBE-125/12B  
ELECTRIC HEATER BATTERY

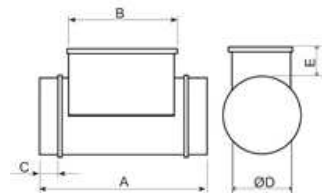

A	B	C	ØD	E
375	278	42	125	105



5211781400 - MBE-125/12B-R 1/230V  
ELECTRIC HEATER BATTERY

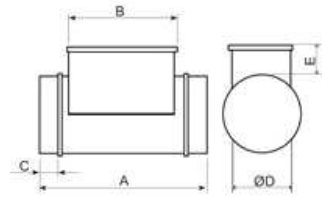

A	B	C	φD	E
375	278	42	125	105



5132864100 - MBW-125

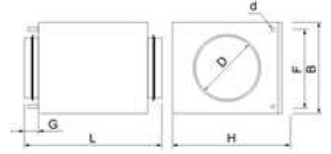

ØD	B	H	d	F	G	L
125	183	225	10	140	40	380



5416744700 - MFL-125 F

Box in galvanized steel for inserting the MFR F5, F6 and F7 filters. Fitted with inlet and discharge circular duct connection flanges with integrated rubber air seal and an inspection cover easy to open for maintaining the filters.

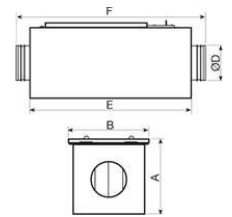

A	B	φD	E	F
213	220	125	450	522



5416591500 - MFL-125 G4

MFL filtration boxes are of G4 grade filtration and are designed for direct connection with standard circular ducting. The MFL-G4 filtration boxes are supplied with a cover easily removable to replace the filter.



A	B	φD	E	φ
206	229	125	154	218



5416368800 - PLENUM RP-200 A

Terminal connector for GRI internal grille. The RP plenums are manufactured from galvanised sheet steel. Six diameters are available for corresponding GRI grilles.

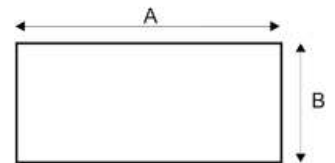

ØD	H	A	B	C	E
125	230	226	208	208	54



5211809800 - SIL-125

Silencer to be installed either at the inlet or outlet of the fan.

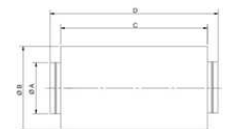

63	125	250	500	1k	2k	4k	8k
-1	-3	-9	-20	-28	-35	-28	-13

A	B	C	D
125	250	600	700



5145890000 - VENT-125NK (220/240V50/60HZ) N6 - IN LINE DUCT FANS

## Sound Performance

	63	125	250	500	1k	2k	4k	8k	Overall
<b>Inlet (LwA)</b>	33	42	54	64	67	66	62	49	71
<b>Inlet LpA @ 1m</b>	22	31	43	53	56	55	51	38	60
<b>Outlet (LwA)</b>	33	43	61	62	63	62	59	47	69
<b>Outlet LpA @ 1m</b>	22	32	50	51	52	51	48	36	58
<b>Breakout (LwA)</b>	20	34	49	45	53	49	50	37	57
<b>Breakout LpA @ 1m</b>	9	23	38	34	42	38	39	26	46



Q=1





5145890000 - VENT-125NK (220/240V50/60HZ) N6 - IN LINE DUCT FANS

## ErP Data

Ecodesign	
Commission regulation (EU) N°1253/2014 of July 2014	
Information requirements (Annex V)	
ProductoComercial	VENT-125NK (220/240V50/60HZ) N6
Trade mark	S&P
Identifier	5145890000
Typology	NRVU unidirectional
Drive	VSD
Type of HRC	None
Thermal efficiency (%)	NA
Qnom (m3/s)	0.04
Pelec (kW)	0.06
SFPint (W/m3/s)	NA
Face velocity (m/s)	1
$\Delta p_{s,ext}$ (Pa)	260.1
$\Delta p_{s,int}$ (Pa)	NA
$\Delta p_{s,add}$ (Pa)	NA
Static efficiency fans (%)	26.7
External leakage rate (%)	2
Internal leakage rate (%)	NA
Filter performance	NA
Filter warning	NA
LWA dB(A)	
www.solerpalau.com	